

Optical Specification	
Model	C2514-10M-V1.0
Resolution	3.45μm
Mount	C Mount
Sensor	1.1"
Focal Length(mm)	25
Adjustion Type	Manual
F NO.	F1.4-F16
Working Distance(mm)	200~∞
Field Angle	2/3" (H×V×D) 20.1° × 15.4° × 24.3°
	1.1" (H×V×D) 31.2° × 23.4° × 38.4°
Distortion	< 0.3%
Weight	0.1kg
Back Focal Length(mm)	10.80
Size(mm)	Ø40.00 × 42.00
Filter(mm)	M37.5 × P0.5
Working Temperature	-20℃~+60℃

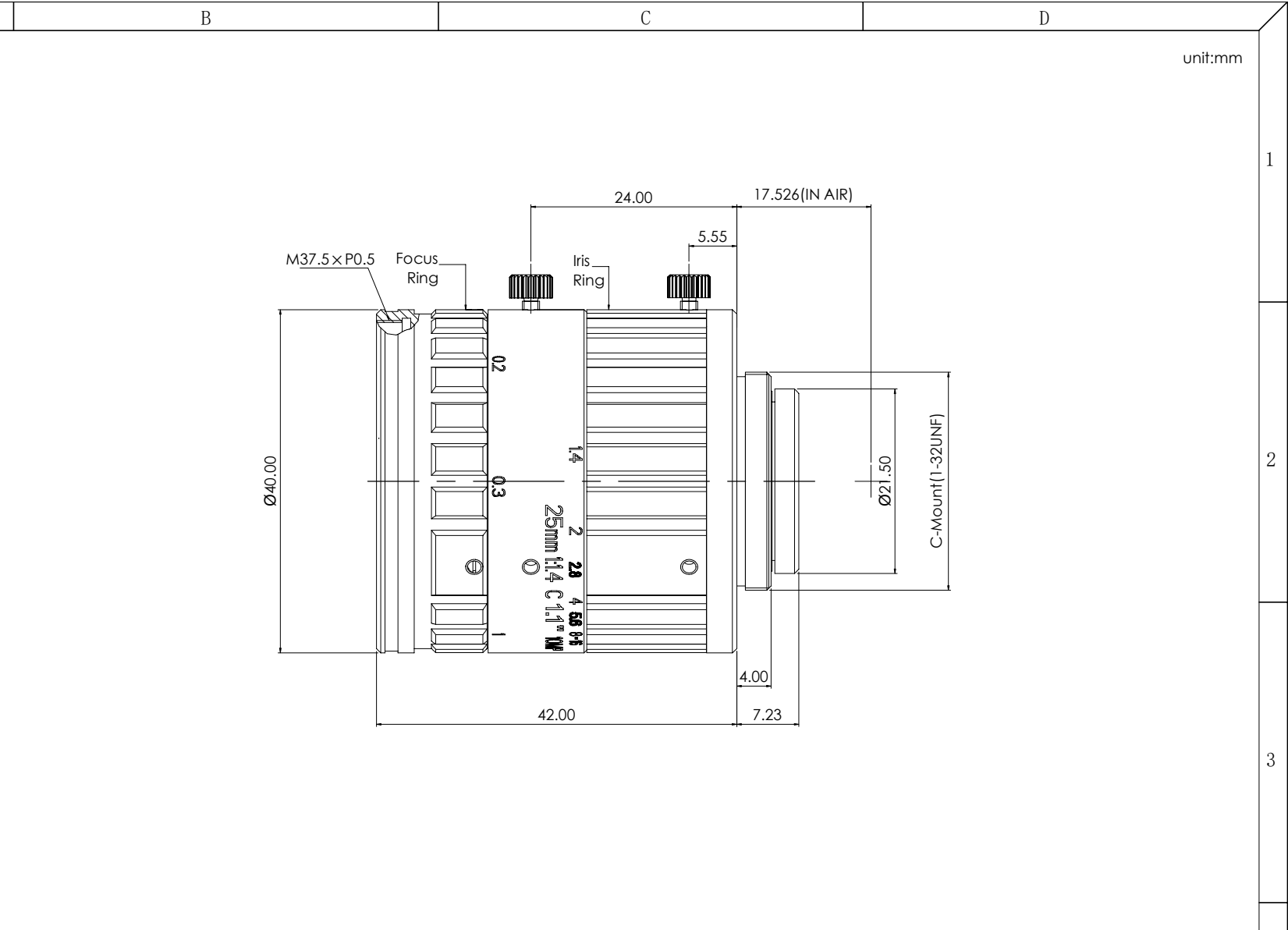

View Angle	
Standard Difference	
IT14	
Drawing Code	

View Angle	Remark	Item	Signature	Date
IT14		Drawing		
		Design		
		Check		
		Approve		
		Paper Size	A4	
Revised Date	2020-12-08	Scale		

C2514-10M-V1.0			
Page	1/1 Total Page	Version	A01